

# MTD EF ELBOWS

PE4710 | 4.7MM TERMINALS | ASTM F1055, F2897, D2513 & D3350



- Universal fittings can be fused in barcode, resistor (dedicated) or manual modes
- 40V Fusion
- Molded from virgin PPI-Listed PE4710/PE100 Resin
- Compliant with ASTM F2897 traceability standards

## 45° ELBOWS

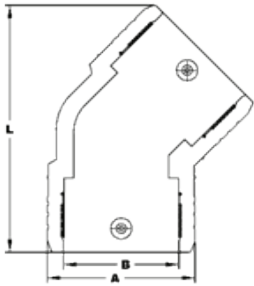

PART NO.	SIZE [in]	A [min]	B [min]	L [min]
TR10420	2 IPS	3.22	2.37	7.27
TR10440	4 IPS	5.56	4.50	9.80
TR10445	6 IPS	8.00	6.61	13.12
TR10450	8 IPS	10.51	8.61	15.13
TR10460	12 IPS	15.76	12.77	21.10

## 90° ELBOWS

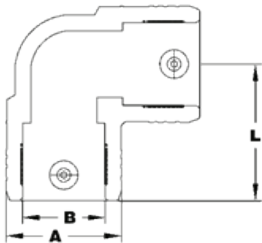

PART NO.	SIZE [in]	A [min]	B [min]	L [min]
TR10472	1 CTS	1.85	1.13	2.55
TR10475	2 IPS	3.15	2.37	3.91
TR10485	4 IPS	5.62	4.50	6.44
TR10490	6 IPS	8.13	6.61	7.71
TR10495	8 IPS	10.80	8.61	9.31
TR10498	12 IPS	15.70	12.76	12.95
TR10499F	16 IPS	23.05	16.02	24.61

## 22.5° ELBOWS

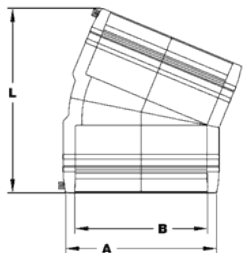

PART NO.	SIZE [in]	A [min]	B [min]	L [min]
TR10415	12 IPS	15.50	12.77	17.86